















| | | | | |
|---|---|--|-------------------------|--|
|  | | Modelo | FAST 80 | |
| | | Código producción | FT800 | |
| | | Interface : | | |
| | |  | | |
| | |  | | |
|  | Dimensión (An x Pr x Al) *Puerta abierta | mm | 724 - 818 - 1529(*2010) | |
| | Dimensión embalaje (An x Pr x Al) | mm | 760x840x1520 | |
| | Peso bruto | Kg | 120 | |
| | Peso neto | Kg | 110 | |
| | Volumen | mc | 0,98 | |
|  | Dimensión cesta | mm | 500x500 | |
| | Max puerta / cúpula abierta | mm | 450 | |
| | Max altura vasos / platos | mm | 425 | |
| | Construcción general | Simple pared | | |
| | Construcción puerta / cúpula | Doble pared | | |
|  | Construcción cuba | estampada | | |
| | Volumen cuba | liter | 15 | |
| | Pot. Res. de la cuba | W | 2.100 | |
| | Filtro de cuba | SI- composite | | |
|  | Tipología de bomba | Doble flujo | | |
| | Pot. bomba de lavado | W | 470 | |
| | Temp. cuba de lavado | °C | 60 (55-->65) | |
|  | Tipología calderín | estándar | | |
| | Volumen calderín | liter | 6 | |
| | Back-flow system | válvula | | |
| | Pot. Res. de la calderín | W | 7.000 | |
|  | Bomba de lavado | NO | | |
| | Pot. bomba de aclarado | W | - | |
| | Temp calderín | °C | 80 (67-->88) | |
| | Consumo de agua | Litre /cesta | 2,1 | |
| | Presión de agua necesaria | bar | 2 - 4 | |
|  | Sistema de desagüe | por gravedad | | |
| | Filtro desagüe | doble filtre | | |
| | Bomba desagüe | opcional | | |
|  | Dosificador de abrillantador | peristáltico | Si | |
| | Dosificador de detergente | peristáltico | opcional | |
|  | Ciclos de lavado | sec | 60 - 90 - 180 | |
| | Ciclos especial | programas | n°1 | |
| | Ciclo de auto limpieza | Si | | |
|  | Voltaje | W | 9.600 | |
| | Conexión electrónica | V - ph - Hz | 400V 3N 50Hz | |
| | Fuse | A | 16 | |
|  | Suavizador | n° 1 | 780131 | |
| | Cesto platos | n° 1 | 780132 | |
| | Contenedor de cubiertos | n° 1 | 780139 | |
| | Cable electrónico | n° 1 | Si | |
| | Manguera de desagüe | n° 1 | Si | |
| | Manguera de carga | n° 1 | Si | |

| | | | | | | |
|---|---|--------------|---|---|------|-----------|
| A |  | Ø 35 mm M | A |  | EXIT | Ø 35 mm M |
| B |  | G 3/4" M | B |  | EXIT | G 3/4" F |
| C |  | Power supply | | | | |



| | | | | | | | | |
|---------------------|---------|-----------|------------|----------------|--|-------|--|---|
| Installation layout | | Hood type | | NH50 | | 00 | |  |
| Designed by: | M. PUCI | Date: | 15.07.2014 | Determination: | | Code: | | |

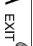
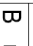
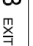
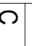
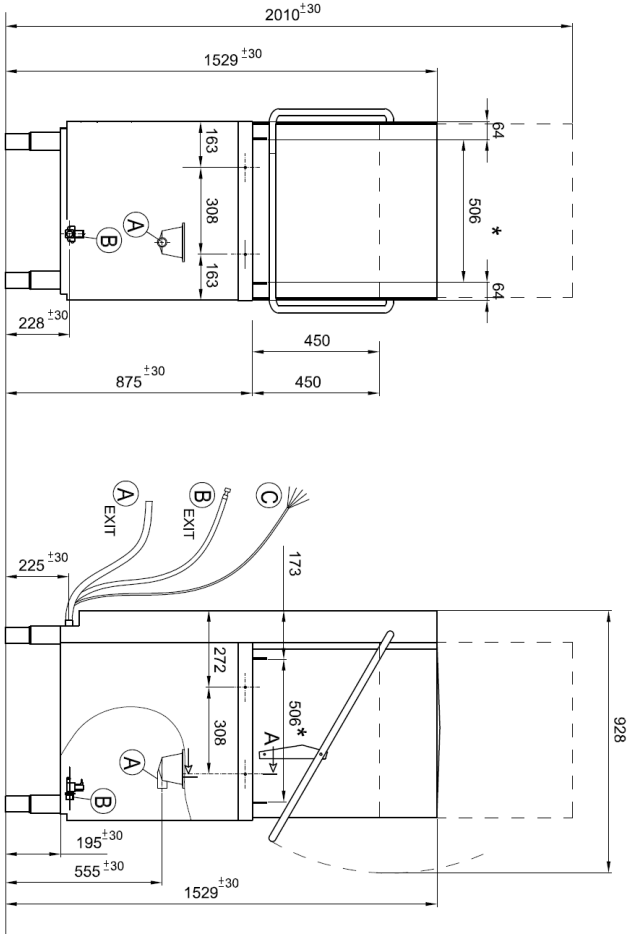
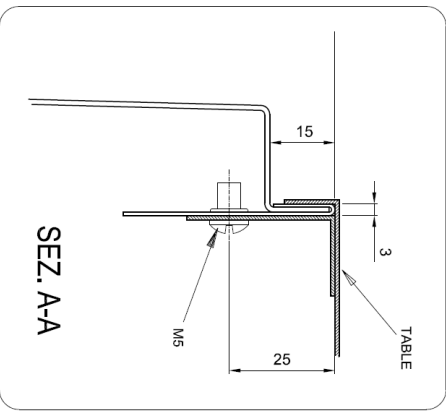
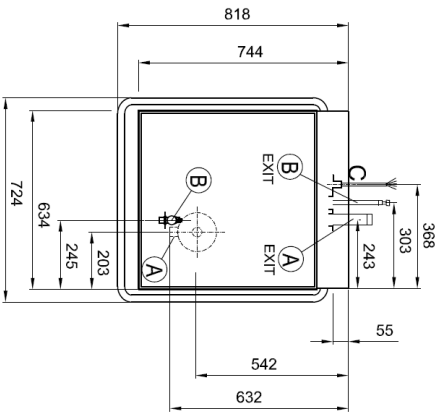
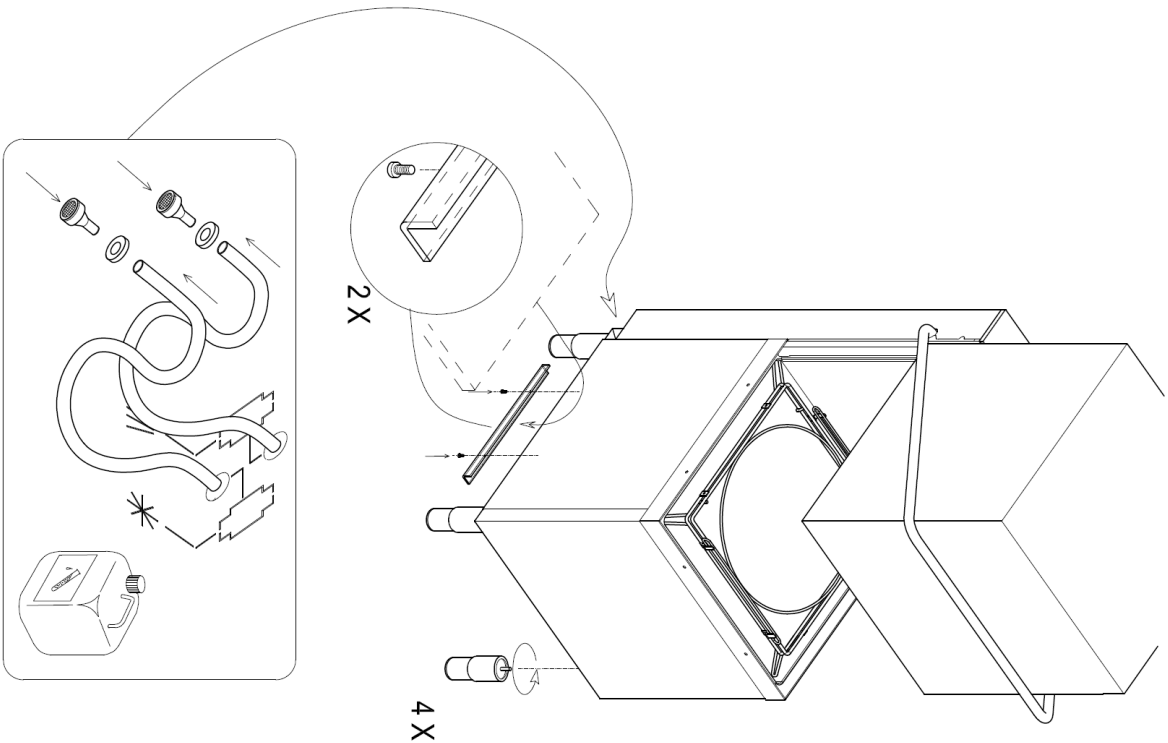

* LUCE UTILE PER CESTELLO
USEFUL SPACE FOR BASKET
LUMIERE UTILE POUR PANIER
NUTZBARE OFFENUNG FÜR KORBE
ABERTURA UTIL PARA CESTO